

SELLER

SHRI RAMESH KR. AGARWAL

S/O LATE MITHULAL AGARWAL  
S. P. MUKHARJEE ROAD, KHALPARA,  
SILIGURI, PO- SILIGURI BAZAR,  
PS- SILIGURI, DIST- DARJEELING,  
PIN- 734005

N

PURCHASER

LANDMARK BUILDERS & DEVELOPERS

MODEL TOWN 1, PRANAMI MANDIR RAOD,  
PO- SEVOKE ROAD, PS - BHAKTINAGAR,  
DIST- JALPAIGURI  
REPRESENTED BY ONE OF ITS PARTNER  
SRI. AJAY KUMAR SINGHANIA  
S/O LATE SHANKAR LAL AGARWAL  
MODEL TOWN- 2, FLAT NO- F3,  
ISKCON MANDIR ROAD, WARD NO-40, SILIGURI,  
PO & PS- SILIGURI, DIST- DARJEELING,  
PIN- 734001

SCHEDULE (ASPER DEED)

PARGANA - BAIKUNTHAPUR ,  
MOUZA- SILIGURI, JL NO.- 110 (88),  
RS SHEET NO.- 3,

RS KH. NO.	RS PLOT NO.	AREA IN Dec.
375	3000	0.52
375	3001	9.48
332	3002	6.00

TOTAL 16.00 Decimal

PS- SILIGURI, DIST- DARJEELING  
LAND UNDER SMC AREA.

-----  
SIGN. OF SELLER

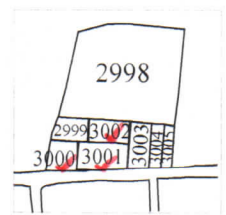
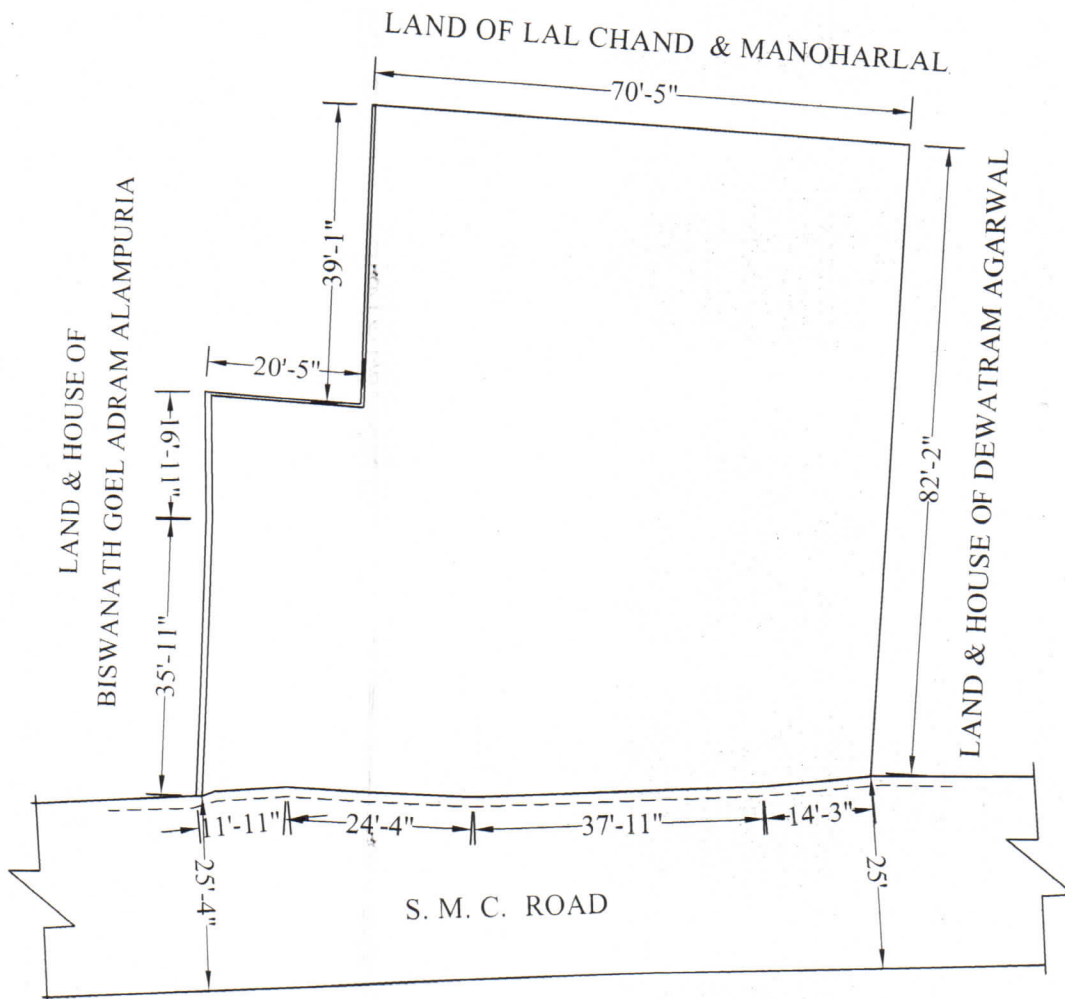

MOUZA MAP RS  
SCALE 16" = 1 MILE

SITE PLAN

SCALE :- 1" = 25'

PREPARED BY

*Ashok Kr. Basak* 20-8-21  
**Ashok Kr. Basak**  
Experienced I.T.I. Surveyor  
Certificate SL, No :- 402  
SILIGURI